

Shock Eye impact indicators offer an economical solution to prevent damage during product transit and reduce damage-related costs.

Shock Eye impact indicators visually deter mishandling and reduce damage-related costs to your product, indicating when products have been exposed to a potentially damaging impact during transit or in storage.

Shock Eye impact indicators are mechanically activated devices. They turn red when an impact occurs over the g-force threshold of the Shock Eye.



Benefits of Shock Eye

- ✓ Alerts carriers about the importance of careful handling and reduces product damage and loss during transportation.
- ✓ Enhances the corporate image by gaining customer trust with the safe delivery of the packages.
- ✓ Reduces workload and time spent on the damaged product claims.
- ✓ Helps identify weaknesses within the supply chain, covering production, transportation, and storage.

Product Features

Provides six different sensitivity levels! Select Shock Eye based on the following

0 to 10kg	10 to 20kg	20 to 30kg	30 to 50kg	50 to 100kg	Over 100kg
Model B90	Model Y80	Model LB70	Model R60	Model P40	Model YG30
• Drop Height 80 ~ 103cm • G value 85 ~ 100G	• Drop Height 62 ~ 75cm • G value 70 ~ 85G	• Drop Height 43 ~ 56cm • G value 60 ~ 75G	• Drop Height 34 ~ 47cm • G value 50 ~ 65G	• Drop Height 16 ~ 25cm • G value 35 ~ 50G	• Drop Height 9 ~ 17cm • G value 25 ~ 40G

* The above values should be treated as a guide, as reaction conditions may vary depending on the drop condition and attachment position of the package.



Reacts to impacts from 360-degree direction: Up, down, left, right, and diagonal!



The lock on the back keeps it safe until just before use!



Warning labels to call attention of package handlers!



How to use Shock Eye

Attaching position

- 1 Attach Shock Eye on the side of the package at an easily visible position.
- 2 Attach Shock Eye to the packaged product just before shipment.

- * It is recommended to attach Shock Eye to the upper right side of the package.
- * One piece of Shock Eye can react to impacts from up down left right directions of the package.
- * To be able to detect impacts from up down left right and front-back directions, attach Shock Eye both to the side and to the adjacent side of the package. (Attach 2 pieces in total)



Handling Method



Check that the central visibility window has not changed to red.



Place warning labels to package.

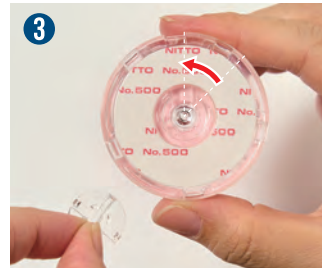

To remove the lock, rotate the knob 45 degrees to the left.

- * Handle with care as it starts reacting to impacts when the lock is removed



Peel the adhesive backing from Shock Eye and simply stick on the warning label.

Product Specifications

Model	YG30 / P40 / R60 / LB70 / Y80 / B90
G value	25G ~ 100G
Shock detection direction	Reacts to all 360-degree impacts
Product size	Φ5cm, Thickness of 0.8cm
Product weight	8g
Warning label SIZE	15cm × 12cm
Material	Case material: Acrylic resin Optional Label: Paper
Operating Temperature	-20°C to 60°C
Number of uses	Disposal
Duration of use	1 year

⚠ Note

- This product is not an instrument for shock measurement.
- This product does not guarantee the quality of the contents after transportation.
- This product is not waterproof or dustproof.

Warning label



Warning labels for sterilized medical devices



Warning labels for precision instruments

JBL Japan Business Logistics Co., Ltd.

Packaging Solutions

3 Kiri-hara-cho, Fujisawa-shi, Kanagawa 252-0811



Contact Us

Please fill out the "Inquiry Form" on the JBL website and send it to us.



https://www.jbl.co.jp/inquiry/contact_pkg03/